



Back Lane

Letchmore Heath

£1,800 Per month

A charming, characterful, two bedroom cottage available in a central Letchmore Heath village location with Davidson Frost-Wellings.

Downstairs is a reception room with exposed-brick fireplace and semi-open plan kitchen. Upstairs are two bedrooms and a family bathroom as well as access to a storage loft.

The cottage has been double glazed and is available with modern kitchen appliances and a patio garden.

Hertsmere Council Tax Band D.

Available in mid August 2026

Security deposit of £2076.92 based on the full asking price

- Charming cottage
- Two bedrooms
- Central village location
- Patio garden
- Unfurnished
- Available mid August

Viewing

Please contact our Davidson Frost-Wellings Office on 020 8954 8806 if you wish to arrange a viewing appointment for this property or require further information.



Floor Plan

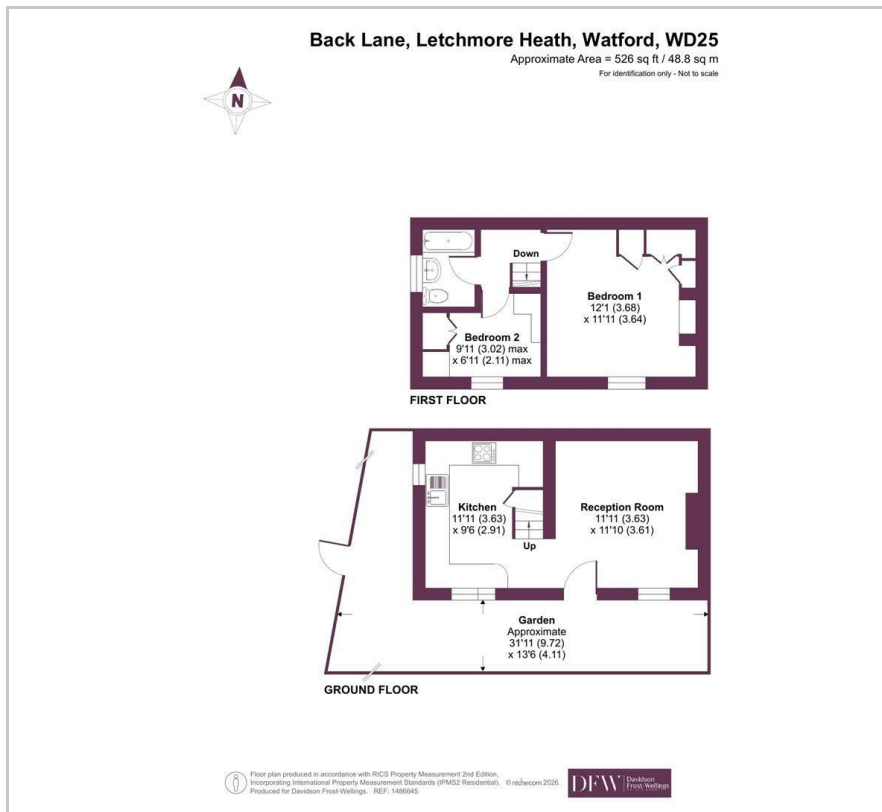

Area Map



Energy Efficiency Rating		Current	Potential
Very energy efficient - lower running costs			
(92 plus) A			
(81-91) B			81
(69-80) C		69	
(55-68) D			
(39-54) E			
(21-38) F			
(1-20) G			
Not energy efficient - higher running costs			
England & Wales		EU Directive 2002/91/EC	



These particulars, whilst believed to be accurate are set out as a general outline only for guidance and do not constitute any part of an offer or contract. Intending purchasers should not rely on them as statements of representation of fact, but must satisfy themselves by inspection or otherwise as to their accuracy. No person in this firm's employment has the authority to make or give any representation or warranty in respect of the property.